

SECTION A-A

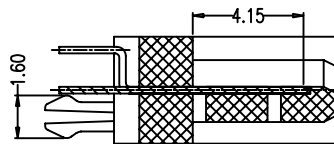

SECTION B-B

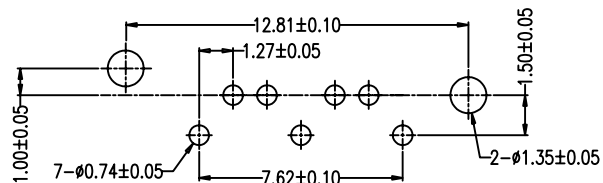

PCB LAYOUT

Notes:

*Material

Housing: LCP, UL 94V-0 rated, Color: Black;
 Contact: Brass;
 Plating: Gold plating over Nickel on contact area; Tin plating on solder tail .

*Mechanical

Insertion Force: 45N max.
 Withdrawal Force: 10N min.
 Durability: 500 cycles.

*Electrical Specification

Current Rating: 1.5 Ampere per contact;
 Contact Resistance: 30 Milliohms max.
 Insulation Resistance: 1000 megohms min.
 Dielectric Withstanding Voltage: 500 V AC.

*Environmental

Operating Temperature: -55°C to +125°C

RoHS Compliance

ORDER INFORMATION
 SATA-102 I -A XX

- GOLD PLATING OPTION:
- XX=S1, GOLD FLASH
- XX=S2, 5u"
- XX=S3, 10u"
- XX=S4, 15u"
- MATERIAL:
- A = BLACK, LCP, UL94V-0
- TYPE:
- I = INTERNAL USE
- TOOLING FAMILY
- SATA SERIES

TOLERANCE	
LINEAR	ANGLES
X. ±0.50	X° ±10°
.XX ±0.25	.XX° ±2°
.XXX ±0.13	

GENESIS
 TECHNOLOGY, INC
 A Genesis Electro-Mechanical Company

7F, No. 191, Sec. 2
 Chung-Yang Rd.,
 Tu-Cheng City,
 Taipei Hsien, Taiwan

TITLE:
 SATA SIGNAL PLUG DIP TYPE2 CONNECTOR

PART NO. SATA-102I-AXX

DWG NO. GTI07-25059

[A]	PART NUMBER CHANGE	SWL	05/02/08'	.X ± 0.38	.X° ± 5°	APPD:	MAT'L:
[X01]	ISSUED	Daniel	11/22/07'	.XX ± 0.25	.XX° ± 2°	CHKD:	FINISH:
REV.	ECN NO.	NAME	DATE	.XXX ± 0.13		DRWN: Vegas	Q'TY:

	UNITS	SCALE	SHEET	REV
	mm	NONE	1 OF 1	A